



HWAM

North America
Hearth Products Catalog 2011

Welcome to HWAM North America

Our goal is to bring International Class hearth products to our customers in North America. We have selected these products for their superior design, functionality, reliability, and craftsmanship. We also believe that using these products will help minimize our impact on the environment.

In this catalog we are proud to present wood stoves and fireplaces from HWAM AS, and Burner Fire Starters from Burner AS.

You can light up a HWAM stove with a clear conscience, since burning wood is a CO₂-neutral process, which means that no additional CO₂ is given off to the environment. The CO₂ captured in the wood is simply released again, so the wood gives off the same amount of CO₂ as if it were decomposing on the forest floor. Many years of development work have made these stoves extremely efficient, enabling them to utilize nearly all the energy in the wood. The smoke coming out of the chimney consists mainly of water vapors, resulting in a minimum strain on the environment, unlike heating with oil, gas or coal.

HWAM is committed to making their stoves even more efficient and environmentally friendly. HWAM stoves meet the rigorous Norwegian environmental standards on minimizing the amount of hazardous particles and gasses, which are among the most restrictive in Europe. This means that with a HWAM stove you will get a heating source with a very high level of efficiency, which in turn gives you more environmentally friendly heating for your money.

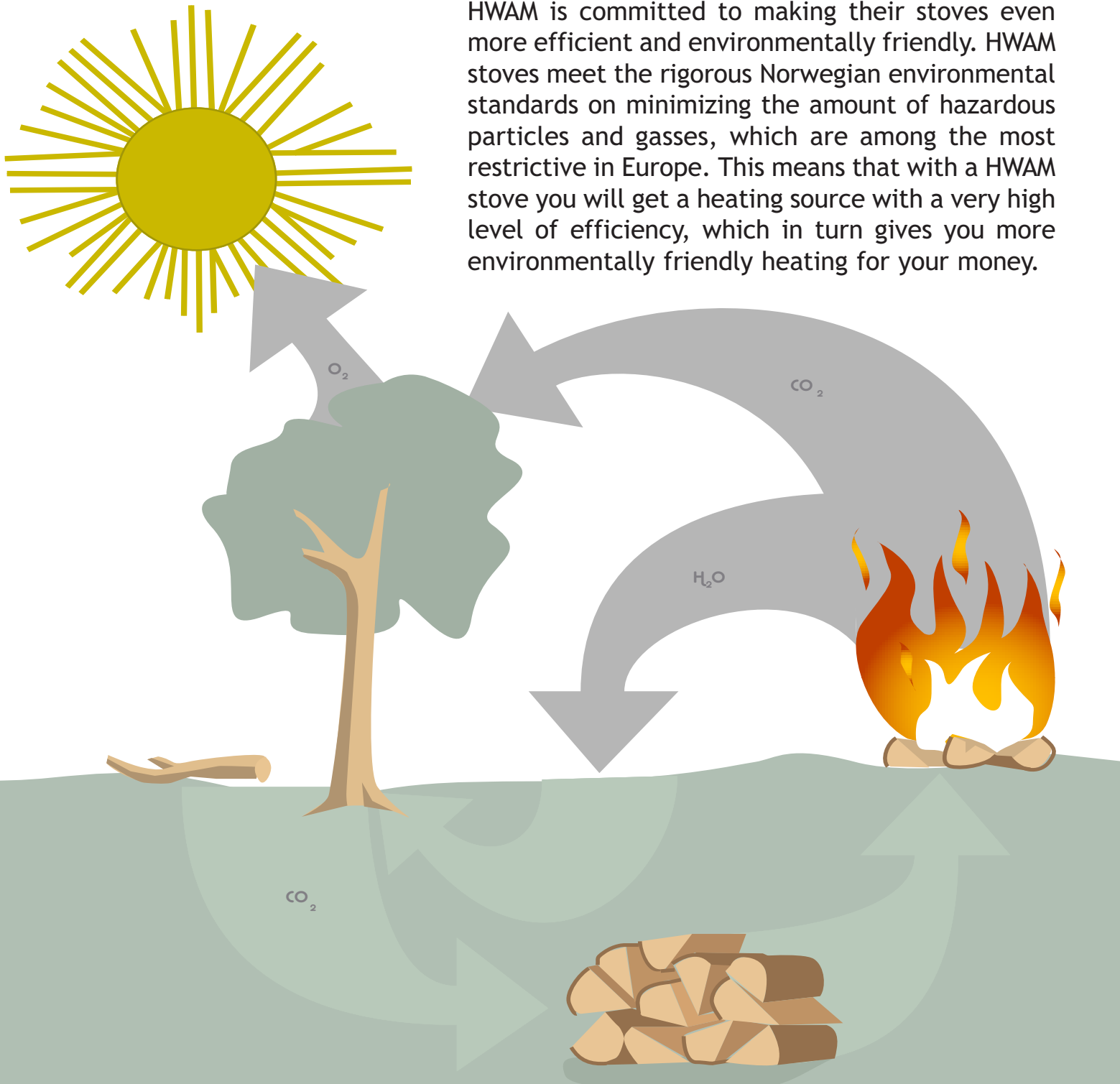

HWAM

wood stoves and fireplaces

"The furniture-like finish with rounded inner and outer corners, ends and edges, yields a friendly appearance, that is pleasing to the touch; it's also designed to prevent wear-through of the paint on exposed places, and make cleaning easy, unlike designs with sharp inner edges that are impossible to clean." Designer: Architect Anders C. FASTERHOLDT

Monet

The curved panoramic glass front and the spacious sunken combustion chamber are placed at a practical height, which makes it easy to light the stove, and enjoy the flames.



Designer: Architect Anders C. FASTERHOLDT

The Vertical orientation of the Monet and the small footprint give you great flexibility in where to place the stove. It can be placed near the connection between two rooms where it can be seen from both. The large viewing area and curved glass allow the flames to be seen from a wide angle. The Monet can be installed 6" to a combustible wall. This means it will not project as far into possible travel paths.

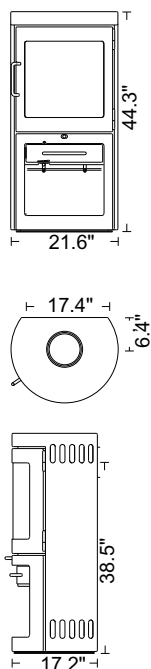

Monet w. wood section and soapstone, grey

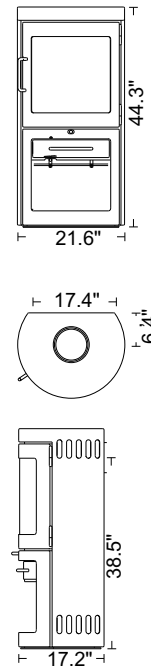

Monet w. wood section, black

NOTE: Monet stoves are shown with a European handle style. The handle is different in North America. Please see owner's manual for details.

HWAM *Monet*

Technical Specifications

Heat output	10,200-27,300 BTU
Average heat output	20,500 BTU
Flue outlet	6"
Heating capacity	1600 sft.
Efficiency	81%
Weight	324 - 331 lbs.
Weight w. soapstone	540 - 547 lbs.
Chimney draft	12 Pa
Connec. from floor, rear	38.5"
Connec. from floor, top	42.4"
Firebox size	15"h x 15"w x 10"d

Options

- Top flue outlet or rear flue outlet
- Drawer or wood section
- Fresh air system
- Soapstone sides with top/rear flue outlet
- Soapstone top with top/rear flue outlet
- Color: Black or Grey

Features

HWAM Automatic™

Approvals

UL 1482 ULC C627 EPA Emissions 3.4 g/hr

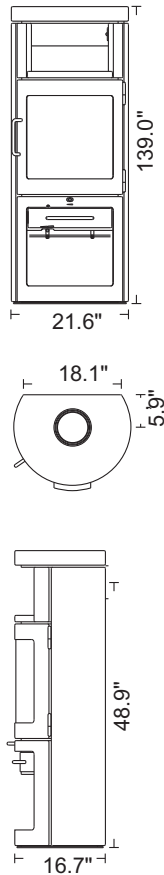

Monet H w. oven & soapstone, grey

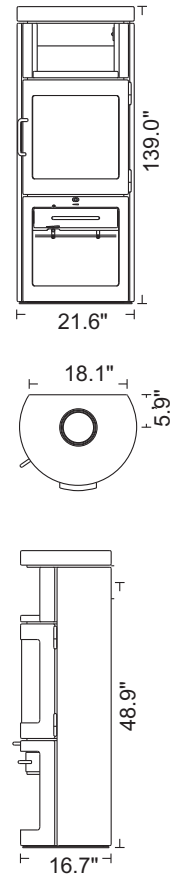

Monet H w. wood section & oven, black

NOTE: Monet stoves are shown with a European handle style. The handle is different in North America. Please see owner's manual for details.

HWAM *Monet H*

Technical Specifications

Heat output	10,200-27,300 BTU
Average heat output	20,500 BTU
Flue outlet	6"
Heating capacity	1600 sft.
Efficiency	81%
Weight	390 - 397 lbs.
Weight w. soapstone	644 -650 lbs.
Chimney Draft	12 Pa
Connec. from floor, rear	48.9"
Connec. from floor, top	52.9"
Firebox size	15"h x 15"w x 10"d
Oven size	9.75"h x14.0"w x 7.5"d

Options

- Top flue outlet or rear flue outlet
- Drawer or wood section
- Fresh air system
- Soapstone sides with top/rear flue outlet
- Soapstone top with top/rear flue outlet
- Baking section
- Color: Black or Grey

Features

HWAM Automatic TM

Approvals

UL 1482 ULC C627 EPA Emissions 3.4 g/hr

Hwam fireplaces



Insert Series I-30



The large glass pane can be opened upwards in a single, elegant, sliding motion that, in spite of its size, can be opened with just one hand. Not only is it user-friendly and pleasing to the eye, but the motion also creates a partial vacuum that minimizes the risk of ash escaping into the room.

With the glass pane up, there is unobstructed access to the deep combustion chamber where the firewood lies safely and stably in place. If the glass pane is in need of a quick cleaning, it can be removed with a simple snap, tilted out and cleaned without any hassle.



Fireplace Designers: Strand + Hvass

Christina Strand and Niels Hvass are both graduates from the Danish design school, Danmarks Designskole, and together they operate the Strand + Hvass design studio. They have been designing high-quality furniture in the studio since 1998, winning numerous design awards for their work; in 2003, they were awarded "Le prix de l'esthétique" in Paris for their "Menuet" chair. Most recently, in 2006, Strand + Hvass, together with HWAM Heat Design, won a "red dot" Design Award for the HWAM 3320 wood-burning stove. Christina Strand and Niels Hvass experiment with shapes and materials, creating simple functional products with a unique identity, which brings out the true nature of the materials in a dynamic design concept that flows from classic Danish design and style.

“Good design is carefully thought-out design, created from commitment and love. That, if anything, requires you to be able to put yourself in another person's place, and be attentive towards the functional and aesthetic requirements, which the design aims to fulfill”

HWAM I-30/55



Technical Specifications

Heat output	13,700-34,000 BTU
Average heat output	20,500 BTU
Flue outlet	6"
Heating capacity	1900 sft.
Efficiency	79%
Weight	216 lbs.
Chimney draft	12 Pa
Firebox size	10"h x 22"w x 12.5"d

Options

- Top flue outlet
- Rear flue outlet
- Fresh air system
- Color: Black

Features

HWAM Automatic™

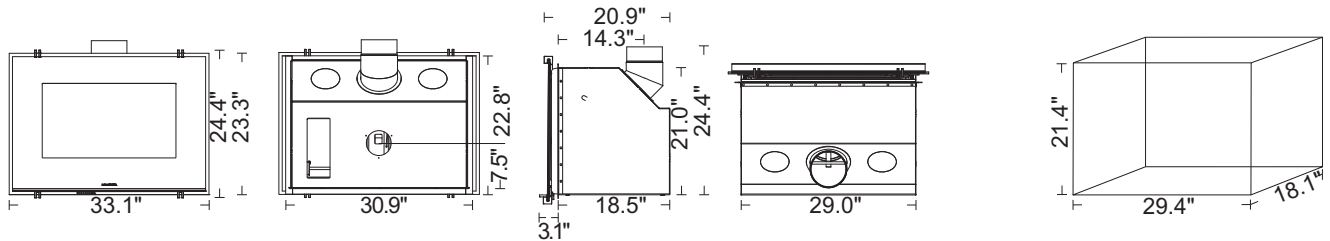

HWAM I-30/65



Technical Specifications

Heat output	20,500-47,800 BTU
Average heat output	34,100 BTU
Flue outlet	6"
Heating capacity	2800 sft.
Efficiency	79%
Weight	278 lbs.
Chimney draft	12 Pa
Firebox size	10"h x 32"w x 12.5"d

Options

- Top flue outlet
- Rear flue outlet
- Fresh air system
- Color: Black

Features

HWAM Automatic™

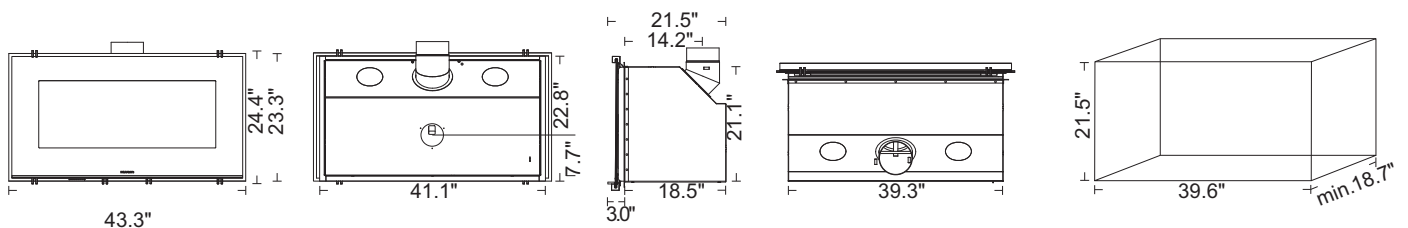

Design and function meet in the HWAM I 30/65. 35 thousand Btus provide effective heating with a 30-inch wide view of the flames visible behind a discreet glass panel. Despite its size, the door opens upward in a smooth sliding motion, and the simple styling is an elegant addition to any home.



I 30/65

Beautiful and well-proportioned, impressive in size and performance. A wood-burning stove which makes visual demands on its surroundings, but which offers a generous payback in the form of friendly heat that spreads to every corner of the room.

Design: Architect Anders C. FASTERHOLDT



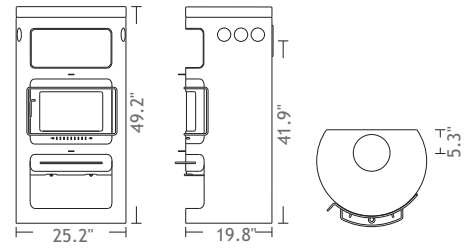
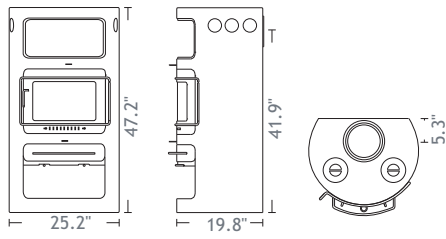

HWAM *Classic 7H*

Technical Specifications

Heat output	27,300-48,800 BTU
Average heat output	37,600 BTU
Flue outlet	6"
Heating capacity	2800 sft.
Efficiency	79%
Weight	405 lbs.
Weight w. soapstone top	483 lbs.
Chimney draft	12 Pa
Connec. from floor, rear	41.9"
Connec. from floor, top	45.9"
Firebox size	13"h x 18"w x 15"d
Oven size	10"h x 18.5"w x 10"d

Options

- Top flue outlet or rear flue outlet
- Soapstone top with top/rear flue outlet
- Color: Black or Grey

Features

HWAM Automatic™

Approvals

UL 1482 ULC C627

Emissions: Qualifies as an EPA exempt cookstove

HWAM Automagic

Brilliant solutions are often simple little details which nevertheless make a huge difference in our everyday lives. HWAM's patented automatic system consists of a small spring which automatically regulates the supply of air to the combustion chamber.

Simple, convenient operation - The automatic system optimizes the combustion for you, completely. All you need to do is to light up the stove and enjoy the flames and the heat to the fullest. When you add more firewood, the system will automatically readjust the stove to achieve the optimum combustion.

Easier cleaning - Optimizing consumption results in cleaner smoke, reducing the amount of ash and soot. The combustion chamber is designed with a unique window rinsing system that serves to prevent the glass pane from sooting up.

More energy, better economy - The automatic system squeezes out extra energy from the firewood. The improved energy efficiency has been documented on several occasions, and you can expect improvements of 20-30% compared to conventional wood-burning stoves.

Minimum strain on the environment - You can light up your stove with a green conscience, as the cleaner consumption reduces the strain on the environment by reducing resource use, and limiting the amount of smoke and particles released.

All modern wood burning stoves provide adequate, efficient combustion. Unfortunately not all stove owners take the time to discover or understand how to operate their wood burning stoves to the optimum.

Sketches 1 and 2 show the difference between combustion as it occurs when firing with and without HWAM automatic™ combustion optimisation.

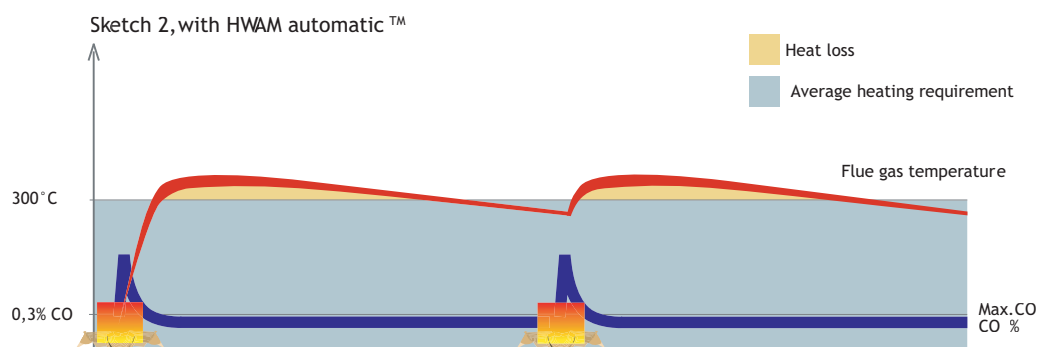
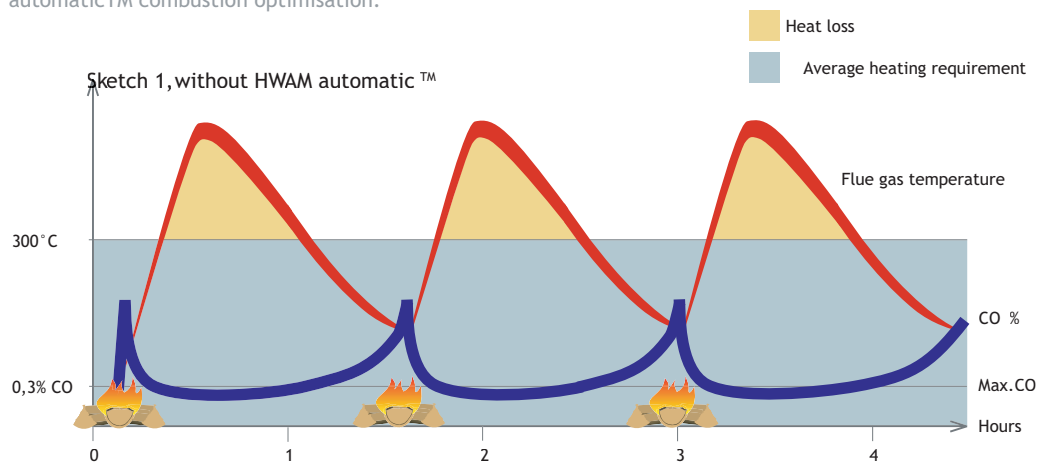

BURNER

F I R E S T A R T E R



BURNER fire starters are the safest way to light up a fireplace, wood stove, or bonfire. These odorless packets are filled with paraffin that is classified as non hazardous and non poisonous.

Visit www.BurnerFirestarter.com for more information and video clips of the product in action.



100 packets/barrel



Retail bag 24

HWAM North America
211 Reservoir Rd.
Plymouth, New Hampshire 03264

www.HWAMna.com
TEL: 603-236-7045
FAX: 866-830-5719
E-mail: hearth@HWAMna.com
Catalog# 2011a

